

Instruction manual



THS 3600
Multi-Channel Receiver
2 x 60W RMS



The installation of this product must be made by a qualified professional.

Index

- 01** • Introduction
 - Presentation
- 02** • Important recommendations
 - Audio sources
 - Package content
- 03/04** • Knowing your equipment
 - Front panel
- 05** • Protection system
 - Knowing your equipment
 - Rear panel
- 06** • Remote Control Function
- 07** • Bluetooth
 - Bluetooth use Example
- 08** • Example of using P2 input
 - Example of using RCA connector
- 09** • Connection examples - Ceiling speaker
 - Warranty term
 - Technical assistance
- 10** • Technical features

Introduction

Congratulations on purchasing a Taramps product.

Developed in a modern laboratory, with highest technology and highly qualified professionals.

This manual explains all the resources, operations and guidelines for resolving questions that may arise in your installation. Take a time to read it carefully and ensure the proper installation and use of all the benefits that this product can offer.

In case of doubt even after reading this manual, please contact our technical support at the number **+55 18 3266 4050** or our website **www.taramps.com.br**.

Presentation

The TARAMPS THS 3600 is a Multi Channel Receiver developed with high technology to integrate different environments. Compact and powerful it can be used in several applications providing quality sound.

Application examples:

- Environment sound for stores, shops and clinics. It also allows, through the microphone input, that warnings are transmitted via the sound system.
- In your leisure area, gourmet space, country house, etc. Including various audio input options, such as Bluetooth, AUX and USB, it allows the audio sources to be easily changed giving the user flexibility in choosing the preferred audio.

The equipment is automatic bivolt and can be connected to any power plug between 90 and 240V. It has a switching power supply that is more efficient in the consumption of electricity.

If you are not going to use the product for a long time, we recommend that you disconnect from the power outlet.

Important recommendations

-The THS 3600 must be installed in a stable and ventilated place, away from heat and humidity. Avoid locations with direct sunlight.

- Do not block the ventilation holes on the top and rear.
- Avoid falls and impacts.
- Carefully observe the polarity and impedance of the loudspeakers.
- Use cables according to the distance between the THS 3600 and the loudspeakers.

The table below shows the recommended gauges according to the distances:

Until 20m	cables with a gauge larger than or equal to	1 mm²
Until 40m	cables with a gauge larger than or equal to	1,5 mm²
Until 70m	cables with a gauge larger than or equal to	2,5 mm²
Until 100m	cables with a gauge larger than or equal to	4 mm²

- In case of unwanted noise make sure that the cables and connections are in good condition. Leave the volume to a minimum of unused channels.

Audio source

The TARAMPS THS 3600 has the following audio inputs:

1. USB: Flash drive input *
2. MICRO SD CARD *
3. AUX (front): P2 standard auxiliary input.
4. AUX1 and AUX2: RCA standard auxiliary inputs.
5. BLUETOOTH
6. FM radio
7. Microphone input (standard P10)

* The connected device must contain music in MP3 format to be identified by the equipment. Maximum supported size: 64GB.

 We advise you to always have a good antivirus, so there are no problems with the Flash Drive or micro SD card when connecting to the product. Infected devices may cause undesirable effects to the THS 3600, such as: Slow music reading and general failures. Do not use the USB input to connect to the computer or to recharge other devices that have batteries.

Package content

- 01 Multi Channel Receiver THS 3600



- 01 Remote Control



Knowing your equipment

Front Panel

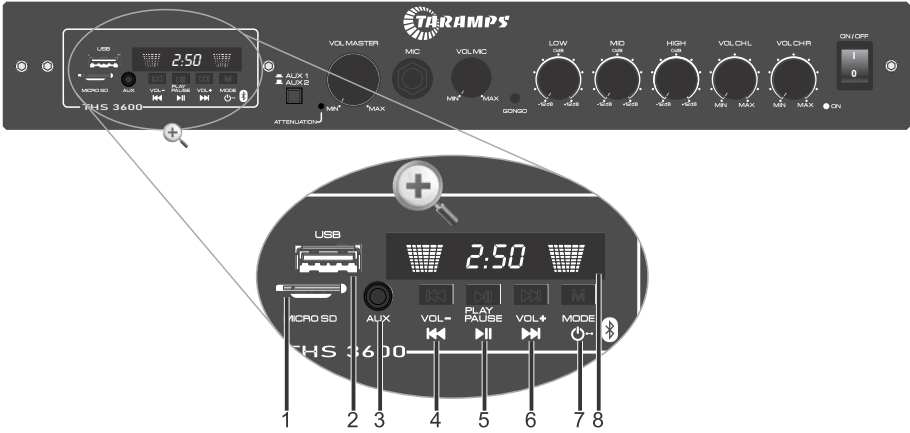

1 - MICRO SD: Micro SD memory card input.  (The card must be positioned as the image shows, with the terminals facing up)

2 - USB: Input to Flash Drive.

3 - Aux. (Connector P2): Receives audio signal from the P2 output of your phone, tablet, MP3, computer, among others. Use good quality cable to avoid unwanted noise.

4 - Short Touch (Track-): Rewind the music tracks in the USB/SD/BLUETOOTH.

Long Touch (Volume-): Reduce the volume in all sources options.

FM: Short Touch: Reduce 0.1MHz of the frequency. **Long:** Automatic search to previous stations.

5 - Short Touch (Play / Pause): Pause or start the music to USB / SD / BLUETOOTH.

Short Touch: Mute to AUXILIARY option

FM: Short Touch: Advances next saved memory position of FM stations. **Long:** Searches for FM stations and saves them in memory.

6 - Short Touch: (Track+): Forward the music tracks in the USB/SD/BLUETOOTH.

Long Touch: (Volume +): Increase the volume in all sources options

FM: Short Touch: Increase 0.1MHz of the frequency. **Long:** Automatic search to next stations.

7 - Short Touch (MODE): Changes the source options, such as: USB / SD / AUXILIAR / BLUETOOTH / FM.

Long Touch - To turn off the device. (The device will stay in stand by mode)

Turning the device off via this button does not disconnect the microphone input from it and the ON LED on the front panel will remain on. To switch the device off completely, use the ON / OFF switch on the front panel.

8 - LED Display - Remote control IR sensor: For better communication between the remote control and the device, point the control at this point on the display.

Knowing your equipment

Front Panel (sequence)

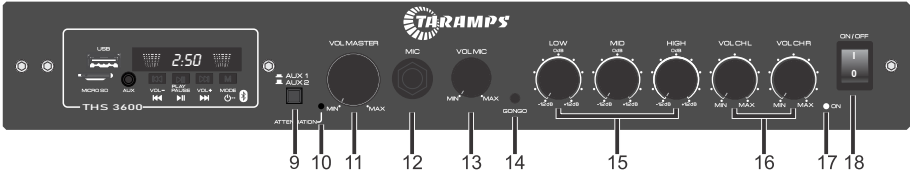

9 - AUX1 / OPTICAL or AUX 2 KEY: Button pressed: Selects AUX1 and Optical inputs.
Button not pressed: Selects the AUX 2 input. (Inputs on the rear panel).

10 - ATT: LED audio attenuation indicator. When identifying an audio signal from the microphone input or emitting the ding-dong signal (GONGO), the equipment attenuates the output signal, allowing higher evidence of the microphone. After 2 seconds without using the microphone, it returns to the state without attenuation.
It is possible to enable or disable this function. With the device in standby mode, press and hold the gong key for 5 seconds. The ATT LED will flash 3x with the function enabled or 1x with the function disabled.

11 - VOL MASTER: Controls the global volume level and must be used to adjust the output power desirable.

12 - MIC: P10 input for microphone.
Microphone Recommendations:

- The microphone signal has a low amplitude, so improper use can cause unwanted noise.
- Use quality cables and connectors.
- Do not wrap the microphone cables.
- Do not pass the microphone in front of the loudspeakers. This causes feedback.

13 - VOL MIC: Adjusting the volume of the microphone and the GONGO (ding-dong). If you do not use the microphone and GONGO, it is recommended to keep the volume to a minimum.

14 - GONGO: GONGO activation key.

The product has 3 GONGO options. To select another option with the device on, press and hold the "GONGO" key. The 3 gong patterns will be emitted in sequence (do not release the key). To select an option, release the "GONGO" key after hearing the desired option.

15 - EQUALIZATION: Ways equalization adjustment
LOW: Bass frequencies
MID: Middle frequencies
HIGH: High frequencies.

16 - VOL CHL / VOL CHR: Adjust each channel level (L ou R).

17 - LED ON: Indicates that the product is turned on.

18 - TECLA ON/OFF: Main ON/OFF switch.

Protection System

The THS 3600 has a protection system against outputs overload and outputs short circuit. When the protections are activated, the ON LED on the front panel turns on temporarily and the audio output is interrupted. About 2 seconds, or the audio is restored. If the protection system or system meets frequently, review the settings and installation of your system.



Knowing your equipment

Rear Panel

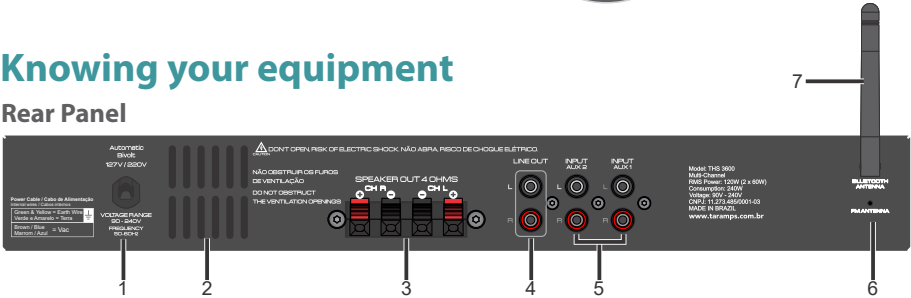

1 - POWER CABLE: Plugged into a powered outlet. This product operates from 90V AC to 240V AC 50Hz/60Hz..

2 - VENTILATION HOLES: Do not obstruct the rear ventilation and the upper ventilation (cover) for the product to perform better.

3 - SPEAKER OUT: To connect the loudspeakers. Follow the indicated polarity and the recommended minimum impedance of 4 ohms for each channel.

4 - LINE OUT: The LINE OUT output allows to send the audio signal (not amplified) to other equipment, such as another THS 3600, an amplifier or active subwoofer. The LINE OUT sound is affected by the 3 Band Equalizer and Volume controls. (LOW, MID, HIGH and VOLUME controllers)

5 - INPUT AUX 1, OPTICAL e AUX 2: Audio inputs. Use the frontal key to select.

6 - FM ANTENNA: Indoor wire antenna for FM radio reception. Position the wire antenna in order to achieve the best FM reception.

7 - BLUETOOTH ANTENNA: External antenna for better reception of the Bluetooth range.

Remote Control Function

O THS 3600 has a compact remote control, so you can remotely control the device with practicality.



ON / OFF: Press the key to turn off:
USB / BLUETOOTH / SD / AUXILIAR / FM.

Turning the device off via this button does not disconnect the microphone input from it and the ON LED on the front panel will remain on. To switch the device off completely, use the ON / OFF switch on the panel.

Mode: Switch the audio source (USB, BLUETOOTH, SD, AUXILIARY, FM).

MUTE

PLAY / PAUSE: Pause or start the music to USB / SD / BLUETOOTH.
FM: Short Press: Advances next saved memory location of FM stations.
Long Press: Searches for FM stations and saves them in memory.

TRACK - Previous track (short press)
FOLDER - Previous folder (long press)
FM: Short Press: Previous 0.1MHz of the frequency.
Long Press: Automatic search to the previous station.

TRACK + Next track (short press)
FOLDER + Next folder (long press)
FM: Short Press: Next 0.1MHz of the frequency.
Long Press: Automatic search to the next station.

EQ: EQUALIZATION: Pop / Rock / Jazz / Country / Normal.
Do not work in auxiliary mode.
FM: Short Press Return to the saved memory position of FM stations.

VOL-: Volume down

VOL+: Volume up

RPT REPEAT: Repeat / play MP3 options

U/SD: Switch mode between USB / SD Card
FM: Searches for FM stations and saves them in memory.

NUMERIC KEYBOARD: FM: Long Press saves FM stations.

Bluetooth

When selecting the Bluetooth function (identified with "bt" on the display), the THS 3600 waits for a Bluetooth connection. Search for the device called "TARAMPSTHS 3600" using your phone, tablet, PC or other and match it.

-To connect to a new device, disconnect the current one and make the new Bluetooth pairing. Bluetooth specification: class II with a 10m maximum range and may vary according to the environment (such as walls) and the connected device.



For other devices the connection system is similar (consult manufacturer's manual)

Bluetooth examples of use

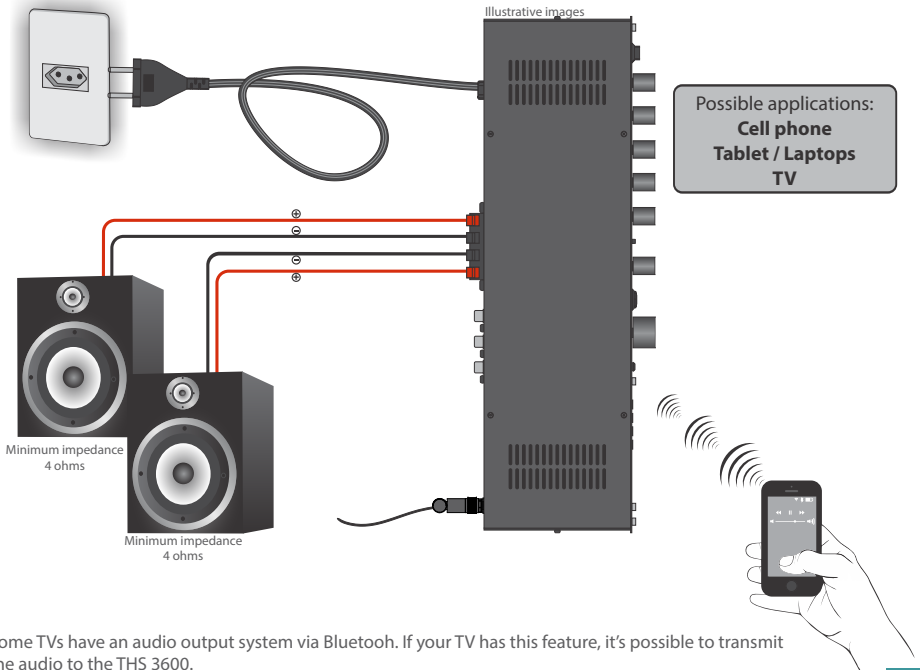

Some TVs have an audio output system via Bluetooth. If your TV has this feature, it's possible to transmit the audio to the THS 3600. Consult your TV manufacturer's manual.

Example of using P2 Connector

Select the AUX mode on the 'MODE' key.

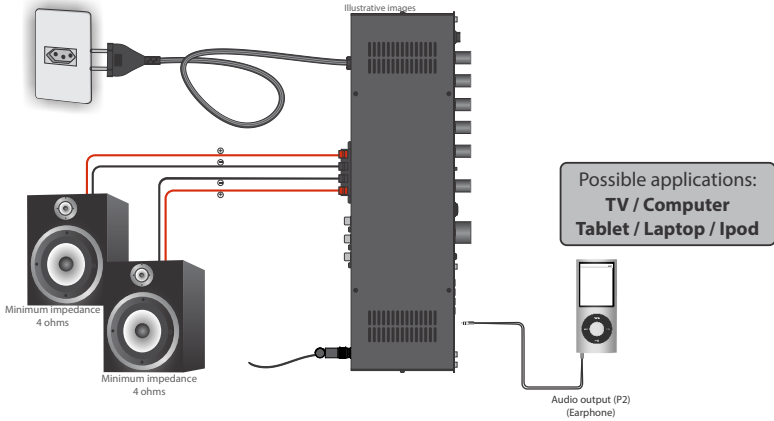

Example of using RCA input

Select the AUX mode on the "MODE" key and the AUX 2 key not pressed.

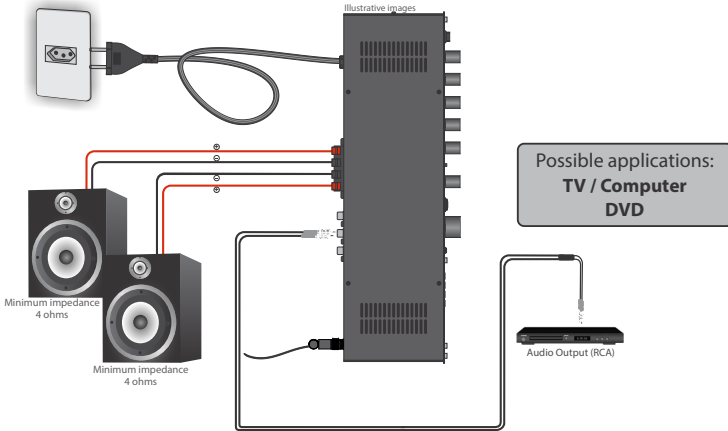

Connect control use example (Long range transmitter)

The THS 3600 is compatible with the CONNECT CONTROL, TARAMPS long range remote control which allows you to control your sound over wide distances and without the need to point the control at the device.

The THS 3600 does not lose the functionality of the USB port, as the connect control allows a Flash Drive to be plugged into its USB port. If your CONNECT CONTROL version does not work directly, use the LEARN function to copy the keys from the original control.

* For more details on the CONNECT CONTROL TARAMPS functionalities consult in its manual on the website.

Note: Connect Control Taramps are sold separately.

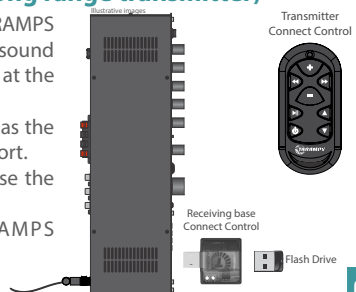

Connection examples - Ceiling speaker

Examples to until 16 loudspeakers 8 ohms each

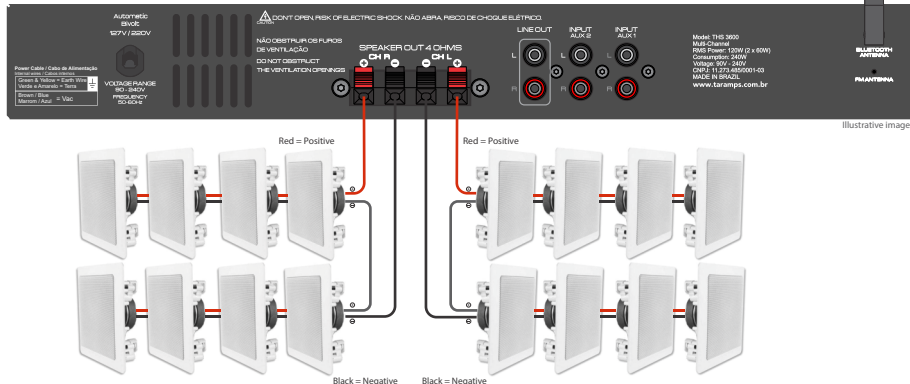

Illustrative images

For this kind of connection use cables with a minimum gauge of 1.5mm² for up to 40 meters. For long distances, consult the table on page 12 "Important recommendations". It's necessary to make connections in parallel and series as shown in the example, to match impedance.

Term of warranty

TARAMPS, located at Julio Budisk highway, SN, KM 30 – Alfredo Marcondes, SP - Brazil, ZIP CODE 19180-000, warrants this product against any defects on terms of project, making, assembling, and/or with solidarity, due to project vices which cause it improper or inadequate to its original use within 12 months from the date of purchase. In case of defect during the warranty period, TARAMPS responsibility is limited to the repairing or replacement of the device of its own making.

This warranty excludes:

- Damaged products by improper installation, water infiltration, violation by unauthorized individuals;
- Tamper or torn warranty seal;
- Cases in which the product is not used in adequate conditions;
- Defects caused by accessories, modifications or features attached to the product;
- The product with damage from falling, bumps or nature related problems (flooding, lightning, etc);
- Warranty card is not properly filled or torn;
- Costs involving uninstallation, reinstallation of equipment as well the shipment to the factory;
- Damage of any kind, due to problems in the product, as well as losses caused by discontinued use of the product.

Technical assistance

For international support, check on our website:

www.taramps.com.br/en/rede-de-assistencias-tecnicas or contact direct the factory support:

Phones: +55 18 3266-4050 / +55 18 99749-3391

E-mail: service@taramps.com.br

Technical features

TARAMPS THS 3600:	Receiver Multi Channel Class D
Number of Channels:	02
RMS Power:	120W (60W + 60W)
Nominal RMS Power of each channel:	60W (1%THD+N)
RMS output voltage for each channel:	15,5Vrms (1%THD+N)
Total Harmonic Distortion + Noise (THD + N) at the nominal power of each channel (60W)	<1%
Each channel nominal Impedance:	4 Ohms
MIC Sensitivity:	10mV
AUX input Sensitivity:	200mV
MIC input impedance:	2,2K Ohm
AUX input impedance:	2,2K Ohm
Frequency response (equalizers at 0dB):	15Hz ~ 20KHz (-3db)
Typical 3-way equalizer performance:	
Low (bass):	±12dB - 80Hz
Mid (mid bass):	±12dB - 2KHz
High (high):	±12dB - 10KHz
Power supply:	90 ~ 240V AC (automatic) – 50/60hz
Maximum consumption:	240W
Consumption in Stand by:	0W
Internal protection fuse:	3A
Protection System:	Output protection against short-circuit and low impedance**
Ratio signal/noise:	>70db
FM frequencies:	76 MHz ~ 108MHz
Dimensions:	386 x 59 x 142mm (15.20" x 2.32" x 5.59")
Weight:	1.45Kg (3.15lb)

* Nominal power with 1KHz sinusoidal signal and 4 ohms resistive load.

** Protection system on page 15.

The values mentioned are typical and may change due to the tolerance of components or the manufacturing process. For more information or questions visit our website or contact TARAMPS support.



Taramps reserves the right to modify the contents of this manual without prior notice and not to apply the modifications to units previously produced.



+55 18 3266-4050

Manufactured by:
TARAMPS ELECTRONICS LTDA
TAX ID: 11.273.485/0001-03
Rodovia: Júlio Budisk, SN, KM 30
Alfredo Marcondes - SP
Made in Brazil
www.taramps.com.br